

Program Information

# **2017 SNU Development Cooperation Policy Program (DCPP)**

**Master's Degree Program in International Studies**

August 10, 2017 – December 31, 2018  
Seoul, Korea



Graduate School of International Studies  
Seoul National University

*\*Participants are strongly advised to thoroughly read and follow the provided instructions in the Program Information.\**

**PART I. PROGRAM OVERVIEW**

**PART II. HOW TO APPLY**

**PART III. PROGRAM CONTENTS**

1. ACADEMIC SCHEDULE
2. CURRICULUM
3. EXTRA CURRICULAR ACTIVITIES

**PART IV. TRAINING INSTITUTE**

1. GENERAL INFORMATION
2. ACCOMMODATION
3. CAMPUS LIFE
4. HEALTH CARE

**PART V. SUPPORT SERVICE**

1. TRAVEL TO KOREA
2. EXPENSES FOR STUDY AND LIVING
3. OTHERS

**PART VI. REGULATIONS**

1. ACADEMIC REGULATION
2. EXAMINATIONS AND GRADE EVALUATIONS
3. CODE OF CONDUCT (PARTICIPANT'S RESPONSIBILITIES)
4. TEMPORAL LEAVE
5. ACCOMPANYING OR INVITING FAMILY
6. OTHERS

**PART VIII. CONTACTS**

## Part I

# PROGRAM OVERVIEW

■ **Program Title: Master's Degree Program in Development Cooperation Policy Program**

■ **Duration:**

- **Stay duration: August 10, 2017 ~ December 31, 2018** (17 Months of study in Korea)

*During their 17 months in SNU, students are strongly recommended to complete their thesis.*

- **Academic duration: September, 2017 ~ August, 2019** (24 Months)<sup>1</sup>

*In accordance with the university regulations, the diploma will be issued in August 2019.*

■ **Degree: Master of International Studies (International Area Studies)**

■ **Objectives**

- 1) The objective of this capacity reinforcing program is to match the aim with SNU GSIS's Scholarship Program (SP) in order to reach closer to achieving the original goal of the SP.
- 2) Program Purpose: To develop human resources, strengthen organizational competency, support building Development Cooperation Policy related policy development system, improve understanding of Korea and build amicable relations with participants' countries
- 3) Expected Effect: Strengthen abilities of individuals and organizations in charge of practices and policy makings in the field of Development Cooperation Policy, construct an environment for economic and social growth in developing countries by achieving the program purposes such as improving policies and reinforcing partnership with Korea.

---

<sup>1</sup> The majority of the participants complete their thesis during the 17 months. Completion of the thesis at one's home country is rarely accomplished.

▣ **Training Institute**

Graduate School of International Studies (GSIS) (<http://gsis.snu.ac.kr>)  
Seoul National University

▣ **Language: English fluency that requires no translation**

▣ **Accommodations:**

- **Seoul National University Dormitory (Gwanak Residence Halls)**

**1. APPLICATION ELIGIBILITY**

- Public officials or public sector employees from relevant ministries and affiliated institutions designated by the hosting school (This refers to person working in state-run organizations such as government enterprises, public banks, research institutions, public schools, or person working in ministry or department of national development or public policy making institutions, ministry of foreign affairs or affiliated ministries, or other related organizations.)
- Those with practical or international experiences of more than 3 years are preferred.
- Should hold a bachelor's degree or higher, that is officially recognized by the applicant's government. Majors in Economics, Political Science, Social Sciences, Business and Public Administration, and Social Engineering are preferred. (Private sector employees are not eligible).
- A good command of both spoken and written English to take classes conducted entirely in English and to be able to write academic reports and thesis in English.
- Additional points are given to those who submit officially authorized English test scores. (See table below)

TEPS SCORE	TOEFL		
	CBT	IBT	PBT
Above 748	Above 257	Above 103	Above 613

- Preferably under 40 years of age and in good health, both physically and mentally, to complete the program.
  - Final selection of students will be based on those who are eligible according to local health checkups.
  - Pregnancy is regarded as a disqualifying condition for participation in this program.
  - Having Tuberculosis or any kind of contagious disease is regarded as a disqualifying condition for participation in this program.

- Should not be a person who has withdrawn from KOICA's scholarship program.
  - Candidates who have submitted false documents to the belonging institution or returned to his/her country arbitrarily in the middle of an SP program cannot apply.
  - Should not have participated in KOICA's scholarship program or any of the Korean government's Scholarship Program before (Master's degree program).

## 2. ADMISSION PROCESS

- Admission Decision Procedure
  - Round 1: Evaluation of Application Package
  - Round 2: Telephone Interview and Essay Test
  - \* Note: Interview and Essay Test will be conducted only for those applicants who pass the evaluation of Round 1. The interview will be conducted shortly after the Essay Test in Round 2.
- Application & Registration Timetable\*

Procedure	Dates
Step 1. Closing Date for Applications	April 9, 2017
Step 2. Document Review	April 11-26, 2017
Step 3. Phone Interview and Essay Test	May 15-23, 2017
Step 4. Final Admissions Decision	June 9, 2017
Arrive in Korea and move to the dormitory of Seoul National University	August 14, 2017

\* Please note that the dates are subject to change.

## 3. CHECKLIST OF DOCUMENTS TO BE SUBMITTED

- Seoul National University Form 1: Application Form

- Seoul National University Form 2: Personal Statement and Study Plan (Type in English and Print out)
- Seoul National University Form 3: Recommendation from two different professors with stamp or signature on the sealed envelope by the recommender. (Download twice and to be completed by each of your two professors.)
- Official Bachelor's Transcript and Degree/or Graduation Certificate (Documents written in Korean or English are acceptable. Original Copy or Notarized Copy along with the Notarial Certificate.) Transcripts and Certificates from Chinese universities MUST be accompanied by verification from the China Academics Degree & Graduate Education Development Center. Refer to the website <http://cdgdc.edu.cn>
- A copy of the Applicant's Passport (or other official documents indicating your nationality)
- Copies of Parents' passports (or other official documents indicating parents' nationality such as an Identification Card)
- Official document indicating a parent-child relationship between the applicant and their parents: Applicant's Birth Certificate or Household Register proving the parent-child relationship (In the case of deceased parents or divorced parents, relevant proof needs to be submitted, such as Death Declaration Certificate or Divorce Certificate.)
- Seoul National University Financial Certification Form 4
- Seoul National University Form 5: Verification of Academic Record (Print out the form and sign your name on the Letter of Agreement. Do not fill out the Verification Report portion.)
- Curriculum Vitae
- Certification of Employment and Career Certificate
- Certificate providing English Proficiency (Please submit a score report of a recognized English Proficiency Test such as TOEFL, TEPS, IELTS or any other supporting documents which demonstrate appropriate English language proficiency.)

\* **Refer to Seoul National University Form 1~5 attached separately.**

## 4. IMPORTANT NOTES FOR ALL APPLICANTS

- All SNU forms should be typed in English and not in handwritten forms. And all documents should be in English. If the documents are in any other language, you must submit a notarized / certified translation (in English or Korean) completed by a public notary in the country in which the document was originally produced.
- If any of the submitted materials contain false information, admission will be rescinded.
- Original documents should be submitted. Should they be unavailable, copies must be authorized by the originating institution before they are submitted.
- Applicants whose forms and supporting documents are incomplete or unsatisfactory will be disqualified from the admission process.
- Be sure to make and keep photocopies of all completed forms. Submitted documents will become the property of SNU and will not be returned to the applicants.
- Verification of Academic Record form will be a part of the application.
- Detailed account of individual admissions decision for each applicant cannot be disclosed.
- Please be sure that, in principle, any modification or cancellation will not be accepted after completing the application.
- Applicants should take full responsibility for any disadvantages due to the mistakes or omissions on the application.
- Applicants, who transferred during their prior course of studies, must submit their full complete academic records from all the applicable institution including Transcripts and Certificate of Graduation / Attendance.
- For more information, including downloadable application forms, please refer to SNU Admission Website (<http://en.snu.ac.kr/apply/info>) or Master of International Studies (<http://gsis.snu.ac.kr>)



**Part III****PROGRAM CONTENTS****1. ACADEMIC SCHEDULE**

NOTE: 1. The schedule below is subject to change.

2. The detailed program schedule will be provided upon arrival.

<b>Session</b>	<b>Parts</b>	<b>Academic Calendar</b>
Preparatory Session	2017/08/14 ~ 2017/08/31	Preparatory session & GSIS Orientation
2017 Fall Semester	2017/08/28 ~ 2017/08/31	Course Registration
	2017/09/01 ~	Fall Semester
2017 Winter Semester	2017/12/22 ~	Winter Semester
	2018/01/26 ~ 2018/02/05	Course Registration for Spring Semester
2018 Spring Semester	2018/03/02 ~	Spring Semester
	2018/03/02 ~ 2018/03/04	Application for Thesis Submission and Submission of Thesis Summary
	2018/03/16	Qualification Test for Writing Thesis
	2018/05/06 ~ 2018/05/11	Course Registration for Summer Semester
	2018/05/23 ~ 2018/05/26	Thesis Proposal
2018 Summer Semester	2018/06/18 ~	Summer Semester
	2018/07/27 ~ 2018/08/02	Course Registration for Fall Semester
2018 Fall Semester	2018/09/01 ~	Fall Semester
	2018/11/19 ~ 2018/11/23	Thesis Oral Defense (Final)
	2018/12/14	Completion Ceremony
	2018/12/17 ~ 2018/12/28	Final Thesis Submission
	2018/12/31	Departure
2019 Spring Semester	2019/03/04 ~	Thesis revision under professor's supervision and completion in home country (if required)

## 2. CURRICULUM

### a. Curriculum & Credits: all 3 credits per course (45 credits)

NOTE: 1. The curriculum below is subject to change.

2. The title of courses can be changed.

Semester	Types	Credits	Course
Preparatory Session		-	<ul style="list-style-type: none"> <li>Global Governance</li> <li>Basic Economics</li> </ul>
2017 Fall	Required	12	<ul style="list-style-type: none"> <li>Understanding East Asia</li> <li>International Economic Relations</li> <li>Research Methodology and Skills</li> <li>International Cooperation</li> </ul>
	Required	-	<ul style="list-style-type: none"> <li>Korean and Korean Culture</li> </ul>
2017 Winter	Electives	6	<ul style="list-style-type: none"> <li>Seminar on Area Studies: East Asia and Globalization</li> <li>Global Leadership and Ethics</li> </ul>
	Required	-	<ul style="list-style-type: none"> <li>Basic Korean</li> </ul>
2018 Spring	Electives	9	<ul style="list-style-type: none"> <li>African Governance and Politics</li> <li>Financial Development of World</li> <li>Research Project in International Area Studies 3 (Economic Development in Latin America, Asia, and Africa)</li> <li>Economic Growth and International Development</li> <li>World Trade Organization &amp; Multilateral Trade Agreements</li> <li>Social Development and International Development Cooperation</li> <li>Social and Political Theories of International Development</li> <li>Labor and Social Policy in Globalizing Economy</li> <li>Transnational Migration and Sociocultural Issues</li> <li>Modern Korean History and Society</li> </ul>
	Required	-	<ul style="list-style-type: none"> <li>Korean and Korean Culture</li> </ul>
2018 Summer	Electives	6	<ul style="list-style-type: none"> <li>Global Social Governance</li> <li>International Conflict Analysis and Development Strategy</li> </ul>

2018 Fall	Electives	9	<ul style="list-style-type: none"> <li>• History of Africa's External Relations</li> <li>• International Financial World: Markets, Institutions, and Policies</li> <li>• Exchange Rates and International Macroeconomics</li> <li>• Topics in International Commerce (Advanced Studies on the WTO Dispute Settlement System)</li> <li>• Advanced Topics in International Development</li> <li>• Seminar in International Commerce 2 (Development Cooperation Theory and Practice)</li> <li>• Understanding International Development Cooperation</li> <li>• Understanding International Human Rights and Refugee Issues</li> <li>• Political Development and Economic Cooperation in East Asia</li> <li>• Comparative Legislative Politics</li> <li>• Studies of International Development Cooperation Policy And System</li> </ul>
2019 Spring	Required	3	<ul style="list-style-type: none"> <li>• Dissertation Research</li> </ul>

**b. The purpose of creating the program and expected effect**

- **(Program purpose)** To provide and support participants with Korea's National Development related experiences accumulated from its development process for participants' enhanced their capacity on National Development issues, strengthen organizational capabilities, and improve related policies.
- **(Expected effect)** For participants to strengthen abilities of individuals and organizations in charge of policy makings and practices through taking courses related to theories and practices of National Development areas, and to contribute to the economic and social development of their home countries.

**c. Course Description**

- Global Governance (Required): This course introduces prerequisite notions and theories about Global Governance which will be the basis for pursuing other advanced topics related to social development field in the following regular semester.
- Basic Economics (Required): This course provides an introduction to current economic issues and to basic economic principles and methods. Economics

is not primarily a set of answers, but rather a method of reasoning. By the end of this course, you will be able to use the analysis practiced in the course to form your own judgments about many of the major economic problems.

- Understanding East Asia (Required): The purpose of this course is to familiarize students with key patterns in political change, economic development, and socio-cultural imagination in East Asia. The course briefly reviews the contemporary history of East Asia before moving on to different perspectives of economy and business, society and culture, and politics and diplomacy. Topics include the development of East Asian capitalism, developmental states and democracy in East Asia, cultural understanding of Asian Values, and the concept of self and others in China, Japan, and Korea. The course will end with a consideration of recent social and political changes in East Asia that are aligned to international resources.
- International Cooperation (Required): This course is designed as an advanced introduction to contemporary theories, debates, and major scholarly traditions in international relations. The primary concern of the course is to examine and assess contending theories of international relations and to logically answer some major international questions of contemporary relevance. The ultimate goal is to enhance students' capacity to think critically about the basic forces that drive foreign policy and international politics, thereby improving their ability to evaluate important real-world issues.
- International Economic Relations (Required): This course introduces students basic theories that explain (1) international trade relations among countries, (2) international macroeconomic relations, and (3) the operation of international monetary systems and financial markets. It provides a systematic exposition of principles and techniques of economic theory that are useful in analyzing economic aspects of trade negotiations. Furthermore, attention is given to various concepts of future international economic orders.
- Research Methodology and Skills (Required): The purpose of this course is to give students critical thinking skills related to communication and research. Critical thinking is a powerful means of learning that transcends traditional learning methods focused on memorization and recall. Critical thinking

emphasizes engaged, independent and creative thinking through the use of skills related to analysis, reflection and meaningful understanding.

- Seminar on Area Studies: East Asia and Globalization (Electives): This course is intended to make students familiar with the methodologies and theories in area studies, and to train them to synthesize a large amount of information and experiences about the field site.
- Global Leadership and Ethics (Elective): This course continues and extends your learning and practice of effective and ethical public sector leadership. The course emphasizes the role and relationships of individuals and teams in the leadership development process. This course is specially tailored for African National Development Policy (ANDP) KOICA Program Participants.
- African Governance and Politics (Elective): This course is designed to understand and rethink the general aspects of African Affairs and the main objective of this course lies in deconstructing the existing misperception on African Continent and reconstructing a more balanced perspective. The reconstructed perspective will, hopefully, lead a more balanced practice in the field for future practitioners. To achieve the goal of our course, the approach will be interdisciplinary and thematic. First, the course is based on a wide variety of disciplines ranging from history, sociology, archaeology, political science, development theory, IR theories etc.
- Financial Development of World (Electives): This course is intended to explore the development of money, banking and finance in Europe, US and East Asia in comparative financial history perspective. Through this course, students are expected to understand different financial systems and financial crises of the world.
- Research Project in International Area Studies 3 (Economic Development in Latin America, Asia and Africa) (Elective): The purpose of this course is to provide students with a unique research opportunity by assisting them in synthesizing their course work on various aspects and levels of development, as it relates to their chosen functional and regional(Africa, Latin America, and Asia) focus. By requiring students to write a major seminar paper and to present it in class for discussion and critique, this course introduces students

- to a wide range of practical tools for project designing, monitoring, and evaluation for the practical studies of contemporary Latin American economy.
- Economic Growth and International Development (Electives): Main goal of this course is to study theoretical models and empirical tools in understanding the process of economic growth and international development. The central question of this course is how to make poor countries rich. To answer this question, we try to understand the sources of the international differences in levels and rates of change of real income and the associated income distribution dynamics within as well as across countries. We learn about these issues by using both theoretical models and empirical data interactively in order to infer the policy implications for the effective development of nations.
  - World Trade Organization & Multilateral Trade Agreements (Electives): This course covers World Trade Organization (WTO) and multilateral trade agreements established through the Uruguay Round negotiations. We will first overview the WTO and then focus in somewhat detail the final results of the Uruguay Round of multilateral trade negotiations. We divide multilateral trade agreements into four parts: trade in goods, trade in services, trade-related aspects of intellectual property rights and institutional issues. Agreements on trade in goods are further divided into three subcategories: market access, customs-related issues, and trade rules. Lastly, this course will look at the future challenges facing the current multilateral trading system. Although this course deals with trade agreements, it will put more emphases on economic interpretation rather than the legal aspects. For this course, outside scholars and experts from policy, academic, and private sectors may be invited as special guest lecturers.
  - Social Development and International Development Cooperation (Elective): This course is designed to introduce a new approach to social development to the existing economic growth-oriented paradigms in the field of international development cooperation. By presenting and comparing a variety of international organizations dealing with social development programs, this course aims to enhance both theoretical and practical learning

effects on social development. The first part of the course will introduce norms and theories of social development which have been shared among international organizations; and the second part will lead to practical issues specializing in diverse agendas such as labor, human rights, local communities, immigration, environment issues, gender, and civil society.

- Social and Political Theories on International Development (Elective): This course is a logical outgrowth of academic endeavors to collect possible scenarios and theoretical frames, all of which provide explanatory alternatives of social and political aspects of international development beyond the dominant paradigm of economic solutions. In this regard, this course is theory-oriented and assumes that all students who take this course have pre-knowledge on main thoughts of political science and sociology.
- Labor and Social Policy in Globalizing Economy (Elective): It is contended that globalization has increased income inequality due to increased competition from abroad. Those who could compete successfully (for example, skilled knowledge workers) have continued to prosper but those who lost (for example, routine manual workers) have faced a sharp decline in income level. And this trend is likely to rise as globalization becomes intensified. It is also argued that Globalization has pushed governments engaged in a "race to the bottom". National governments have been forced to strip away business regulations, reduce welfare programs, and lower labor and environment standards in order to attract more foreign capital and business or to keep local industries at home. To what extent the above contentions are true and warranted by empirical evidence? To the extent they are true, what institutional inventions do we need and what policy options do we have to slow down these trends or to revert them and finally to make globalization serve for the benefits of all people, not just for those of lucky few? With such issues in mind, we will deal with the interactions between globalization on one hand and labor, education, welfare, civil society, and regionalism on the other.
- Transnational Migration and Sociocultural Issues (Elective): Increasing transnational migration generates very diverse sociocultural issues on a global scale. Transnational migration also often provides care workers and

becomes a source of international marriage in many developed countries. This course approaches transnational migration in relation to various sociocultural issues such as identity, assimilation and social integration.

- Modern Korea History and Society (Elective): This course improves student's understanding important issues in modern Korean society. First of all, this course provides an explanation of the status of the Korean Peninsula in the World arena. Moreover, students will deal with crucial topics in modern Korea history, like the division, the Korean War, and the economic growth, and will examine changes in Korean society after modernization. To illuminate North Korean history and society is covered for understanding current Korean issue.
- Korean Language and Korean Culture 1 (Elective): The goal of this course is to effectively implement the Korean language and cultural education for foreign graduate students. Through this course, the students will learn the Korean language and develop skills in reading comprehension, speaking, listening as well as in reporting and writing. Also, in order to understand Korean culture, students will study sentence patterns and vocabulary, as well as gain cultural experience through Korean folk games. This can be substituted for Korean Proficiency Exam for Foreign Students, which is one of the pre-requisites for their thesis.
- Global Social Governance (Electives): This course is designed to deal with new social problems which take place beyond the traditional territories of nation-states under the pressure of globalization. They include a variety of new emerging societal issues such as climate change, human rights, poverty reduction, disease, immigration and so on. By upgrading the frame of social policy which has been mostly considered a traditional sovereignty of nation states to the global level, this course will introduce not only various theoretical approaches to global social governance but also empirical analyses of globalized social policies to tackle these new social problems.
- International Conflict Analysis and Development Strategy (Elective): This course is designed to understand the current nature of international/transnational political issues and to enhance critical and decisional capabilities by understanding the intricate patterns of interactions



among the different spheres of global conflict/security fields. To obtain this objective, the course is organized on three different facets: 1) conceptual and normative understanding of international conflict (identification of 'problematic'), 2) socio-historical analysis with genealogical-archeological comprehension on international conflict/security issues (scientific analysis of problem) and 3) thematic examination on various current cases (political, economical and/or cultural conflicts) accompanied by a specific consideration for possible practical solutions (ethico-practical proposition mainly by focusing on development strategy).

- History of Africa's External Relations (Elective): This course introduces a critical study of the formation of African historical (internal and external) perceptions by examining African relations with external world based on a variety of academic perspectives (history, political science, anthropology, archeology, literature, etc.). The goal is to form a balanced perception of African relations and to establish the basis for a sound mutual recognition between Korea-Africa in order to establish a meaningful future partnership.
- International Financial World: Markets, Institutions, and Policies (Electives): This course will cover both macroeconomic and microeconomic aspects of international finance. This course will also cover institutional aspects of the international capital market. Through combining theory and real practices in the international market, students will understand how the international financial market works, learn various kinds of financial products which are transacted internationally, and study international financial companies and related institutions. Considering these characteristics, this course will be one of the prerequisites for becoming an international specialist in the 21st century.
- Exchange Rates and International Macroeconomics (Elective): The main purpose of the course is to understand the reason for adopting protectionist measures not only in advanced countries but also in developing countries despite the fact that free trade policy is better than protectionism. Understanding the political aspect of trade policy is very important to trade

negotiators as well as students with an interest in trade negotiations, because this aspect is so crucial in formulating the basic position and strategies of trade negotiations, and also because it is needed when governments present the results of trade negotiations to the general public.

- Topics in International Commerce (Advanced Studies on the WTO Dispute Settlement System) (Electives): In our increasingly contentious society and world, more than ever before, a prudent selection of a proper, appropriate method of resolving or settling conflicts/disputes becomes one of the most important tasks of individuals, organizations, communities, societies, and nations. This course will provide students an opportunity to explore three of the most frequently used methods of dispute resolution; namely, mediation, arbitration, and litigation. Through lectures, simulations, and student presentations, students will learn the procedures and actual workings of these three methods in various settings such as WTO, WIPO, and LCIA, internal
- Advanced Topics in International Development (Electives): The goal of this course is to understand and apply the empirical methods in analyzing various phenomena of international development. The main contents include (i) understanding of hypotheses of explaining the macroeconomic mechanisms of cross-country differences in development as well as those of the microeconomic mechanisms of development, (ii) understanding of empirical tools and the background quantitative and statistical methods to test such hypotheses, and (iii) application and exercises using actual data based on such understanding. This course ultimately aims to provide the empirical understanding of the fundamental sources of differences in international development based on real and solid evidence.
- Seminar in International Commerce 2 (Electives): The purpose of this course is to understand the nexus between theories and practices and to acquire the proper tools to analyze the possible practical situations in working places. The lecture content will be based on the experience of experts working in the field of international commerce. Students will have two hours' practice of international commerce per week as the preparation for actual field experience.

- Understanding International Development Cooperation (Elective): This course is designed to deliver the various aspects of foundational theories, historical development, and practical policies in relations to international development cooperation. They includes the following four criteria: (i) international development theories (development economics, social development, political development, and anthropological perspectives); (ii) international development history since the Second World War; (iii) development policy transfers on the basis of actors including states, international aid agencies, NGOs, etc., and (iv) global development architecture. The course will provide a deeper understanding and prospect of international development for graduate students who plan to pursue
- Understanding International Human Rights and Refugee Issues (Elective): This course surveys international human rights norms and procedures, including a detailed examination of global, regional, and national institutions to protect human rights. The course examines key contemporary concepts of human rights and the mechanisms of creating and enforcing human rights norms. Particular attention is paid to refugee issues, which has emerged one of the most serious human right problems in the Post-Cold War world.
- Political Development and Economic Cooperation in East Asia (Elective): This seminar examines the relationship between economic developments and democratization in East Asia like South Korea, Japan, Taiwan and China. Special attention will be paid to related topics such as previous theories of economic development and democratization (i.e., modernization theory, dependency theory, bureaucratic authoritarianism, and developmental state model), the democratization process in the third world, and democratic transition in socialist states like China, Vietnam and North Korea.
- Comparative Legislative Politics (Elective): This course is a customized research course designed to offer students in - depth knowledge and guidance regarding a subject given by a professor of Korean Studies Program. The subject may change depending upon the specialization of professors every semester, and students write in depth practice - oriented research

papers. The professor teaches students how to use relevant theories, and research methods.

- Studies of International Development Cooperation Policy And System(Elective): The goal of this course is to promote the understanding of the history and current issues of international development cooperation policy and system and also the research and debate about the measures to progress the international development cooperation. We review how the international society of development cooperation has been formed and figure out the current situation of international development cooperation, and study various instruments of development cooperation such as knowledge sharing, triangular cooperation, development finance, PPP, and CSV. We study critical topics regarding the design of the system of international development cooperation and also set up the discussion sessions with development cooperation experts in order to deliver opportunities for the students to practice their real understanding from the course.

#### **d. Academic Requirements for Graduation**

- A minimum of 45 credits is required for graduation (including a minimum of 9 credits from Practical Courses).
- Students should take the 5 required courses from all the major program in GSIS
  - ① International Economic Relations
  - ② International Cooperation
  - ③ Research Methodology and Skills
  - ④ Studies in Regional Monetary and Financial Integration or Understanding the East Asia (Select 1 of 2)
  - ⑤ Dissertation Research
- Students should take at least 3 courses (9 credits) in their GSIS major program.
- Students must take courses (credits) to fulfill required credits (45 credits) to be eligible to graduate.

- Students must take at least 3 courses (9 credits) from practical courses in their major or elective program.
- Field Trip (tentative): Comprise of 8 field trips in total during the entire period
  - Industrial Inspection 2 nights and 3 days \* 3 times
  - Field Trip \* 5 times
- Thesis / Action Plan
  - Aside from 'Dissertation Research' course, student choose one of the SNU GSIS professors as thesis adviser before the second semester starts and conduct 1 on 1 individual thesis guidance
  - Thesis Workshops 4 times

### **3. EXTRACURRICULAR ACTIVITIES (TENTATIVE)**

- Start of the Semester and End of the Semester Workshops
- International Development Policy Seminar (3 times per semester)
- Roundtable (Developing Countries, Korean, Latin American, Roundtable, Once a week / During the Semester)
- Home Visiting (Once)
- Experiencing Korean Culture (2 Times)
- Social Events in School (Participating in International Food Festival, Wine and Cheese Party, Together Day, etc.)

## 1. GENERAL INFORMATION

**Seoul National University (SNU)** was founded in 1946 as the first national university in South Korea. The university consists of sixteen colleges, ten professional schools, and one graduate school, and has 135 research institutes and other supporting facilities, all of which are located across two campuses.

Gwanak Campus, the main campus of the university is located at the foot of the magnificent Gwanak Mountain in a 4.8 Km<sup>2</sup> area. The School of Medicine, Nursing and Dentistry and the University Hospital are all located on Yeongeon Campus in downtown Seoul.

SNU offers its students not only the most excellent academic environment possible but also outstanding cultural and recreational opportunities with a wide range of additional entertainment options available in the city of Seoul. SNU has a student enrollment of approximately 28,490; 16,511 at the undergraduate level and 11,979 at the graduate level. About 2,620 full-time faculty members are appointed at SNU. Over 330,000 SNU alumni play a leading role in every sector of South Korean and global society.

**The Graduate School of International Studies (GSIS)** has started as the Center for Area Studies in 1989 to foster research on region-specific issues and to respond to the increasing demand for global perspectives within Korea. In 1997, it has been expanded to the School of International and Area Studies (SIAS) which again expanded to current GSIS in 2003.

The school has a department of International Studies under which runs 4 Programs: International Commerce, International Cooperation, International Area Studies, and Korean Studies.

Since its foundation, GSIS achieved a remarkable success in its quality education of international studies. The objectives of GSIS education is to bring up experts on international and global affairs who meet the challenges of globalization and normalization, equipped with core skills, practicable expertise, problem-solving ability, international awareness, and visions. GSIS educates global leaders for an increasingly complex global society. As both a professional and academic institution, it seeks to prepare its students to assume leading roles in government and non-government organizations, international organizations, multinational corporations, the media, as well as think-tanks and universities. The curriculum is based on an integrated, multidisciplinary approach, which connects theory with practice.

With the most prominent faculty in Korea specializing in international commerce, international cooperation, international area studies, Korean studies, and Development Studies, GSIS provides a truly exceptional research and educational environment.

The student body is composed of highly qualified graduate students from all around the world. As a source of knowledge and skills, GSIS will continue to promote mutual understanding, peace, and prosperity, both regionally and globally.

## 2. ACCOMMODATION

### ❑ Dormitory of Seoul National University (Gwanak Residence Halls)

The Gwanak Residence Halls is the home of 4,777 students from all over Korea and around the world. It provides residents with living quarters not only to study and relax but also to meet people from various backgrounds. Each unit of double-occupancy (sharing a room basis) is furnished with a shower room, two beds, two desks and two cabinets. Each room is supplied with a LAN cable able to provide use of internet and e-mail on hand.

You can also visit homepage <http://dorm.snu.ac.kr/eng/> for more information.

#### ▶ Gwanak Residence Halls

- Address: 1 Gwanak-ro, Gwanak-gu, Seoul 08826, Korea
- Tel: 82-2-880-5404                      - Fax: 82-2-877-2892



- \* Your accommodation will be provided at a double occupancy (sharing a room basis) of Gwanak Residence Halls Bldg. 900-905 and 918 which is the accommodation building for graduate students.



❑ **Layout of Double Occupancy (2 people sharing a room)**

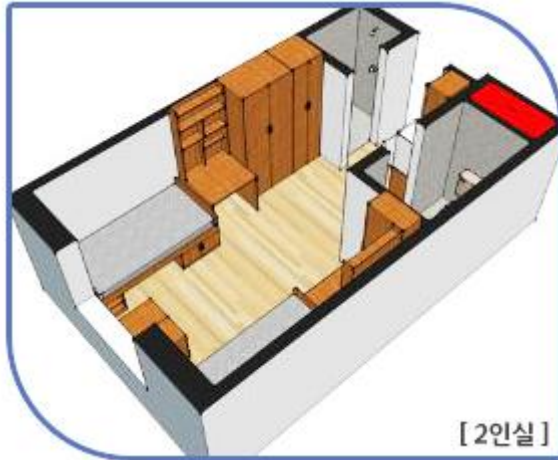

❑ **Facilities**

• **Private Room**

- A small refrigerator, space separation screen and LAN cable provided
- Toilet and shower booth
- Individual heating system
- Each room is furnished with a bed, desk, chair, book case, wardrobe, shoes shelf and curtain
- Each room is equipped with air conditioner, telephone, LAN port and 220V power outlet
- **Personal Items including bed sheet, blanket and pillow are not provided.**
- Possessing or using any of the electric heating appliances is prohibited.

• **Common Area**

- Kitchen: Microwave oven, cooking heater, refrigerator, water purifier, dining table, TV
- Laundry and drying room: Washing machine, electric iron, clothes horses
- Lounge: Snack vending machine, table, LAN port table for internet use
- Reading Room: Basement 1F, Building 900



Up: (Left) Double room (Right) Laundry and Drying Room  
 Down: (Left) Double room (Right) Lounge

- **Security**

- CCTVs, card key, automatic door lock

- **Documents to be submitted (Very Important)**

- SNU requires all dormitory residents to be immunized against certain communicable disease. To comply this regulation, Seoul National University Health Form (attached) <1. **Immunizations (Measles)**> and <2. **Tuberculosis Screening**> items should be completed and signed by your health care provider with the official seal of hospital. **Required vaccinations should be given prior to arrival.**
- Please submit soft copy(\*.pdf) of your **SNU Health Form** to the office via email(koica.snu@gmail.com) by the announced date(TBA) and submit the original copy when you come to school on August 2017.

### **3. CAMPUS LIFE**

#### **Administration Office**

The Office for the Development Cooperation Policy Program is located on the 3rd floor of the GSIS Bldg. 140-1 Room 303.

#### **Student ID Card (S-Card)**

Paper application: Submit S-card application form and one COLOR PHOTO (3cm x 4cm) to the Student Support Center (Bldg. 67, Dure-moonyegwan 2<sup>nd</sup> Floor) at the beginning of the first semester after you obtain Alien Registration Card and update your student records to reflect the new Alien Registration Number.

#### **Finger Print Registration**

After 6PM the main entrance of the GSIS building will be locked. Students can register their finger prints and the password at Building 140-1 Room 303 in order to access the building after 6PM.

#### **Central Library**

This is located behind the main administration building. You will need a student ID card to enter the library and to borrow books and other materials. Their website is <http://library.snu.ac.kr> which has extensive information. You can use your ID card to borrow and extend the due date of books.

#### **International Library**

In response to the needs of a new, globalized era and demands for skillful international specialists, the GSIS Library was organized and has currently been enlarged. In addition to fostering prospective international specialists, the library has contributed to Seoul National University and played a pivotal role in building up the materials that are necessary and useful for domestic researchers of area studies. The library is preparing for the 21st century by producing and administering necessary materials. Recently it has developed into a branch library (International Studies Library) of Seoul National University and is open to various kinds of international as well as Korean researchers.

#### **The Official School Website**

Please refer to the official website of GSIS for general information on the program, academic requirements, upcoming events and notices. (<http://gsis.snu.ac.kr>)

### **Central Library**

This is located behind the main administration building. You will need a student ID card to enter the library and to borrow books and other materials. Their website is <http://library.snu.ac.kr> which has extensive information. You can use your ID card to borrow and extend the due date of books.

### **Transportation**

To reach SNU by subway, get off at either “Seoul National University” or “Nak-Seong Dae” station (Line No. 2).

- ① From the “SNU” subway station: From exit No 3, and take bus No. 5511 at the bus stop. The bus stops in front of Graduate School of International Studies. If you are taking a taxi from the station, the fare is approximately 4,000 won. You may also take any bus that stops at the Main Gate of SNU. GSIS is about 15 mins walk from the Main Gate.
- ② From the Nak-Seong Dae station: Take exit No. 4, and take a town shuttle bus (Ma-eol bus) “Gwanak No. 2” at the nearest bust stop. Get off at the Dormitory Crossroad station and cross the read to take a school shuttle bus. You should get off at GSIS.
- ③ A detailed service route of each bus is provided on the Seoul bus network online service website (<http://bus.seoul.go.kr>)

## 4. HEALTH CARE

: If you have health problems, you have two choices (**a** and **b**).

### **a. Gwanak Campus Health Service Center (located in the Student Union Building)**

The health team at this facility includes physicians, registered nurses, counselors, and support staffs, and is equipped with laboratories, radiology services, a pharmacy.

This center also offers the following specialty services: internal medicine, dermatology, dental, ENT (ear, nose, and throat specialist), gynecology, neuropsychiatry, ophthalmology, orthopedics and surgery.

The Gwanak Campus Health Service Center transfers patients to Boramae Hospital and SNU Hospital when further treatment is needed.

The center also provides health education, immunizations, general check-ups, treatment for tuberculosis, health certification issuance, on-loan first aid kits, and sanitary inspections.

Student Center (Building 63) Floors 3-4  
(<http://health4u.snu.ac.kr/main/english/english.jsp>)

### **b. SMG-SNU Boramae Medical Center**

The nearest and one of the finest medical centers from SNU  
Dongjak-gu, Boramero 5-gil 20 (Shindaebang-dong street #425, Borame Park rear gate) <http://en.brmh.org/index.do>

## **1. TRAVEL TO KOREA**

SNU GSIS arranges and pays for the participants' round trip Korea. The participant is to travel by the most direct route between the Incheon International Airport and a main international airport in the participant's home country. SNU GSIS will cover economy class, round-trip airfare.

If a participant wants to change the flight itineraries, they should pay the additional airfare. The participant is responsible for the issuance of an appropriate visa (which must be the 'study abroad visa [D-2]) necessary for this scholarship program.

Should the participant be unable to get the appropriate visa before the date of entrance, SNU GSIS is unable to provide any assistance and, if it proves necessary, participants may have to return to their respective countries to get the visa issued at their own expense.

## **2. EXPENSES FOR STUDY AND LIVING**

The following expenses will be covered by SNU-GSIS during the participant's stay in Korea.

- Tuition fee
- Accommodation sharing a room basis (mainly the dormitory of a training institute)
- Living & Meal allowance: KRW 1,000,000 per month
- Round Trip Airfare: KRW 2,000,000
- Overseas travel insurance, etc.

## **3. OTHERS**

- Application Fee

- Admission Fee
- Thesis examination and production Fee
- Preparatory session Fee
- Roundtable participation Fee (Development Countries, Korean Studies, Latin American)

## **1.ACADEMIC REGULATION**

### **a. Attendance and Absenteeism**

1. Students are expected to attend all of the classes they have registered for each semester. Any student who, without good reason, has failed to attend class for at least two-thirds of the total classes shall be prohibited from sitting for the exam.
  
2. In the event a student will be absent for any of the reasons below, the student must notify relevant office: SNU GSIS DCPD ([koica.snu@gmail.com](mailto:koica.snu@gmail.com)) to get approval in advance:
  - Death of an immediate family member (grandparents, parents, siblings) or equivalent circumstance
  - Academic planning, field-trips, on-location training, etc.
  - Participation in seminars or conferences (including international ones) as approved by the Dean of the Graduate School
  - Other events as approved by the Dean of the Graduate School
  
3. In the event of student illness or emergency situations, students who will be absent for less than seven days (including holidays and weekend days) need to submit written notification of such absence to relevant offices: i.e. GSIS Office to get the approval of Dean of the Graduate School. For absences longer than seven days, students must submit a written diagnosis by a physician.

### **b. Must reside in a dormitory**

- Students must reside in the Gwanak Residence Halls (dormitory) of Seoul National University
- Living off-campus is not allowed in principle.



### **c. Must abide by dormitory regulations**

- Seoul National University has very strict dormitory regulations and all students must abide by them.
- A student who violates dormitory regulations will be evicted from the dormitory and he/she must return to her country immediately.

### **d. Cooking is only allowed in a dormitory cooking area.**

- Induction, microwave, and water purifier can be used. Each floor has a communal kitchen.
- Cooking in a dormitory room is prohibited.

## **2. EXAMINATIONS AND GRADE EVALUATIONS**

### **a. Minimum Grade Point Average Requirement**

- Students must achieve a minimum a B<sup>0</sup> grade point average to be qualified to write a thesis and to obtain the master's degree.

### **b. Regular Exams and Make-up Exams**

- Regular Exams: Mid-term (7th to 8th week of semester), Final (End of semester)
- Make-up Exams: In the event a student cannot sit for an exam due to illness, or any other emergency, the student must notify the faculty before the test date, and obtain the Graduate School Dean's approval to sit for the exam at another time.

### **c. Qualifications to Sit for an Exam**

- Any student who, without good reason, has failed to attend class for at least two-thirds of the total classes shall be prohibited from sitting for the exam. In the event of illness or emergency situations, students need to provide a written explanation of their absence.

### **d. Scholastic Performance Evaluation Method**

- Scholastic performance will be based on a 100 point score for each course registered. Grades will be based on classroom performance (presentations, attendance) and test performance (mid-term and final exams).

### **3. CODE OF CONDUCT (PARTICIPANT'S RESPONSIBILITIES)**

#### **a. Participants are required**

- to take up the scholarship in the academic year for which it is offered(deferral is not allowed).
- to follow the training program to the best of their ability and abide by the rules of the training institute.
- to reside in the accommodation designated by the training institute for the duration of the course except for holidays or temporary leave.
- to maintain an appropriate study load and achieve satisfactory academic progress for the course. If the participant fails to attain certain grades required by the university, his or her status as a SNU GSIS program participant may be suspended.
- to participate in all activities associated with the approved course of study including all lectures and tutorials, submit all work required for the course and sit for examinations unless approved otherwise by the training institute in advance.
- to notify the training institute in advance and get an approval for temporary leave.
- to advise the training institute of any personal or family circumstances such as health problems or family problems which may seriously affect their study.
- to refrain from engaging in political activities or any form of employment for profit or gain.
- to return to their home country upon completion of their training program.
- not to extend the length of their training program or stay for personal convenience; the university will not provide any assistance and be responsible for extension of their stay.

#### **b. Withdrawals**

- In principle, a participant is not allowed to withdraw from the course at his or her own option once the course starts.
- A participant may withdraw with valid personal or home country's reasons (such as health or work issues) when acceptable to SNU GSIS. In this case, he/she is not allowed to re-apply for SNU GSIS scholarship program for the next two years after the withdrawal.

- If a participant fails to attain certain grades required by the training institute, he or she may be forced to withdraw and return home upon withdrawal. In this case, he/she is not allowed to re-apply for SNU GSUS's scholarship program.
- The participant who withdraws must return to the training institute the living allowance he or she has already received for the remaining period from the date of departure from Korea.

#### 4. TEMPORARY LEAVE

- Participants may take a temporary leave **during the school vacation** (to the participants' home country or for a trip abroad) on the condition that the trip does not affect their schoolwork and as long as they notify the university in advance.
- The university will not pay the airfare for the trip and **his or her living allowance will be suspended from the day of departure to the day of return during temporary leave.**
- If the participant is found to have made an unreported temporary visit to his or her home country or traveled to other countries **or made a trip despite the university's disapproval, he or she may be suspended from the GSIS SNU scholarship.**

#### 5. ACCOMPANYING OR INVITING FAMILY

- As SNU GSIS's Scholarship Program is a very intensive program which requires full commitment and concentrated effort for study, **participants CAN NOT bring any family members.**
- SNU GSIS does not provide any financial or other administrative support for the dependents of the participants.
- If a participant invites family members within the duration of one month, one must take a full responsibility related to their family members travel to and stay in Korea including administrative and financial support as well as legal matters in Korea. The participant is required to sign and submit the Written Pledge with supporting documents by acknowledging their responsibility and conditions of bringing their

family members in Korea in advance. A copy of the Written Pledge is available at GSIS Office.

## **6. OTHERS**

- SNU GSIS will assume any responsibility only within the limit and scope of the insurance for participants.
- SNU GSIS is not liable for any damage or loss of the participant's personal property.
- SNU GSIS will not assume any responsibility for illness, injury, or death of the participants arising from extracurricular activities, willful misconduct, or undisclosed pre-existing medical conditions.
- If the participants break any of the rules of the training institute during their stay in Korea, their status as a SNU GSIS program participant may be suspended.

**1. CONTACT INFORMATION****a. Graduate School of International Studies (GSIS),****Seoul National University**

·Program Manager: Ms. Raemi DO

·Email: koica.snu@gmail.com

·Homepage: <http://gsis.snu.ac.kr>

·Tel: +82-2-880-6877, Fax: +82-2-874-6877